



200 DGR

ΔP Range: 0 to 0.25 upto 7 bar
0 to 5 upto 100 psi

COMBINATIONS

Gauge



Switch

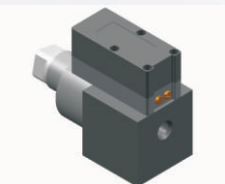

Gauge + switch

(with a terminal strip inside)



Gauge + switch

(with a DIN plug on top)



MOUNTING BRACKETS

Surface mounting

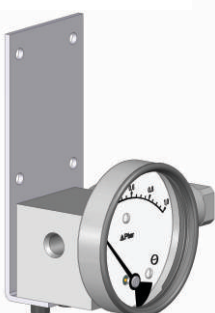

Horizontal pipe mounting



Vertical pipe mounting



Panel / Flange mounting

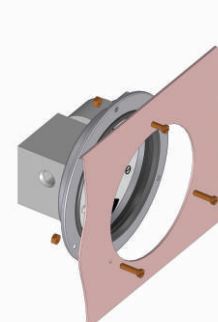

Specifications

Accuracy	±2% of the FSD (Ascending)
Migration	No migration. Zero leakage from high to low port
Range	0-0.25 to 0-7 bar or equivalent ranges in other units
First marking on the scale	15% of the FSD
Sensing element	Diaphragm
Wetted parts	Diaphragm, body material, SS 302 spring & ceramic magnet
Case material & dial size	Stainless steel (SS 304): 2.5", 3.5", 4", 4.5", 6" Engineering polymer: 2.5", 4.5", 6" Bayonet: 4"
Mounting	Direct, front flange, 2" pipe & surface mounting
Maximum working pressure	200 bar / 3000 psi
Maximum process temperature	0 to 80°C (32 to 175°F)
Body material	Aluminum, Brass, SS 316, Monel
Diaphragm	Buna-N, Viton, EPDM
Window	Float glass (Std.), toughened glass, acrylic & safety glass
Connection	1/4" NPT(F) (Std.), 1/4" BSP(F) and others through adaptor
Porting	In-line, rear, bottom, in-line & bottom.
Over range protection	Up to the max. working pressure from high side. <i>Never pressurize only LP side beyond 25 bar</i>
Protection for gauge & switch	IP 65 / NEMA-4

Options

Liquid filling (glycerine/ silicone)
Red follower pointer
Customer logo
Dual scale
Color band
Filter mesh in (+) connection
Descending calibration

Switches (Adjustable in 30-100% of FSD)

1 or 2 SPSTs with a DIN plug
1 or 2 SPSTs with a terminal strip
1 SPST with a built in relay
1 or 2 SPDTs with a terminal strip
1 or 2 SPDTs with a DIN plug

Available in engineering polymer (EP) Case



6.0"



4.5"



2.5"

- Removable glass
- Strong and durable
- Panel mounting possible
- Condensation can be cleaned
- Light weight